

TrailerWIN fix 2024-06

Valid for: TrailerWIN version 2024-01 – 2024-5 manufactured before 4.6.2024.

Description: For Tesla crane ranges 2109-2117 there is an error on position 6 where CoG is in wrong direction. Error only on this certain position, not on other positions.

Solution: Installing the fix will correct the data for Kesla 2109-2117 cranes for position 6, for calculations with this crane model you need to re-select the crane in TrailerWIN in order to read in the new data. If you have used another of the positions there is no need to reselect the crane, they are correct.

Steps:

Note: Following instructions and pictures are examples.

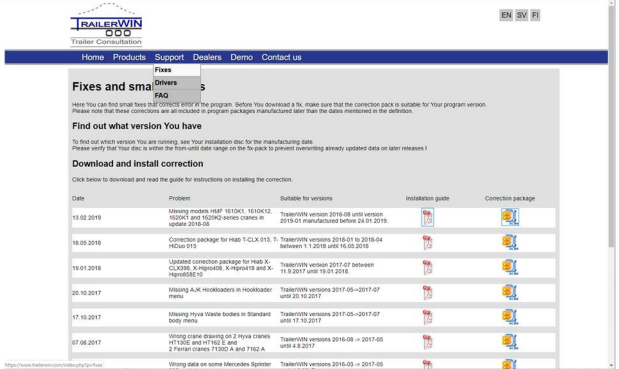
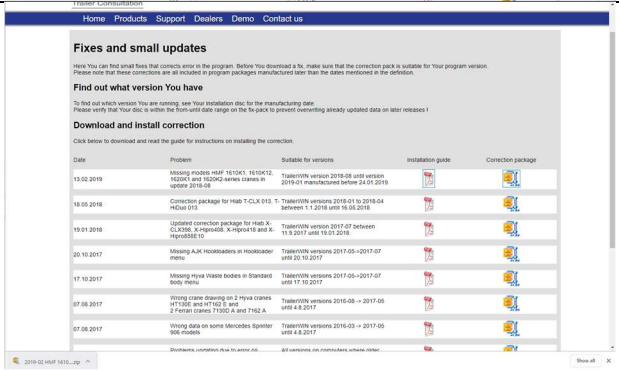
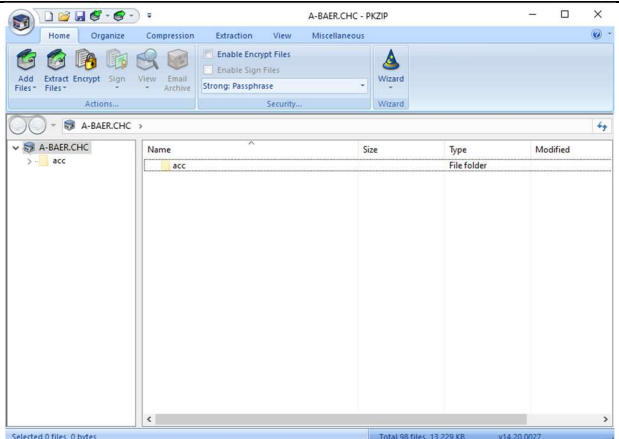
<p>Download the package from www.trailerwin.com (ZIP-file): Click on the ZIP-icon (correction package) and download it to your computer</p>	
<p>Open the zip-file</p>	
<p>When file opens in zip-program Choose Extract</p>	

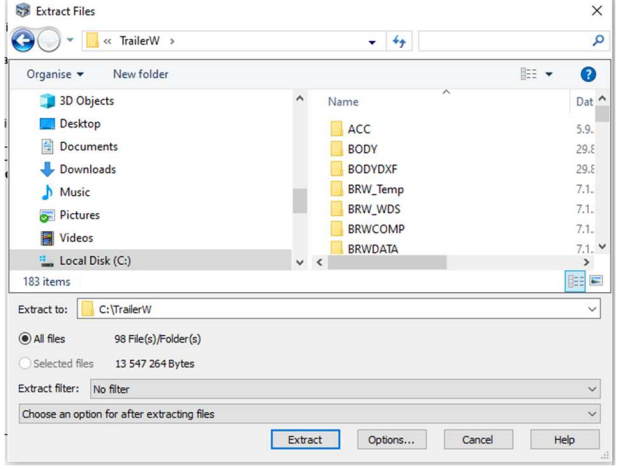
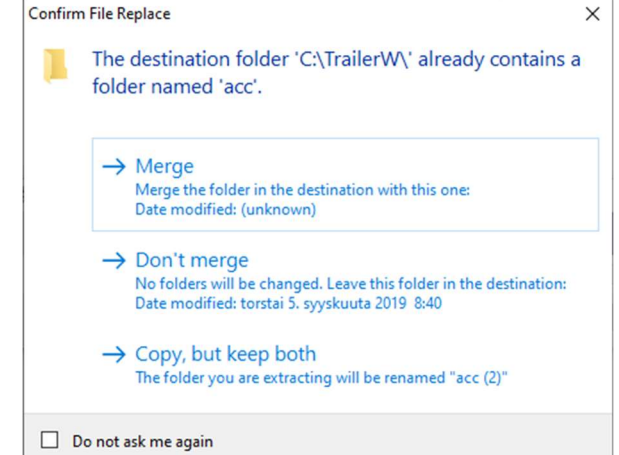
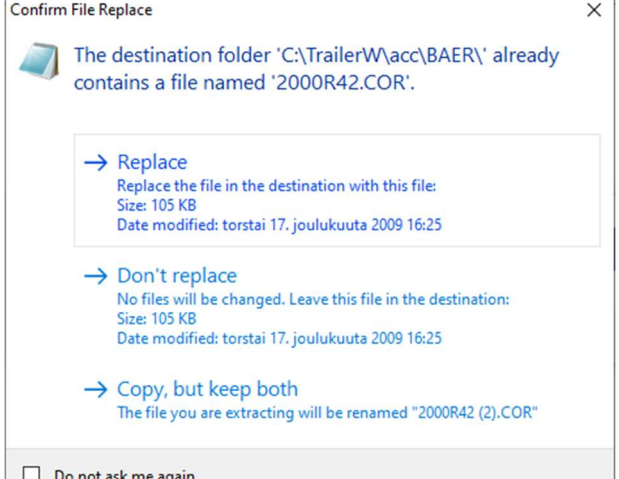
<p>When asked for destination, choose the directory where TrailerWIN is installed. Normally C:\TrailerW. Choose C:\TrailerW</p>	
<p>When warned about folder already exists, Choose Merge</p>	
<p>When warned about same files already exists: Check "Don't ask me again" and click Replace.</p>	

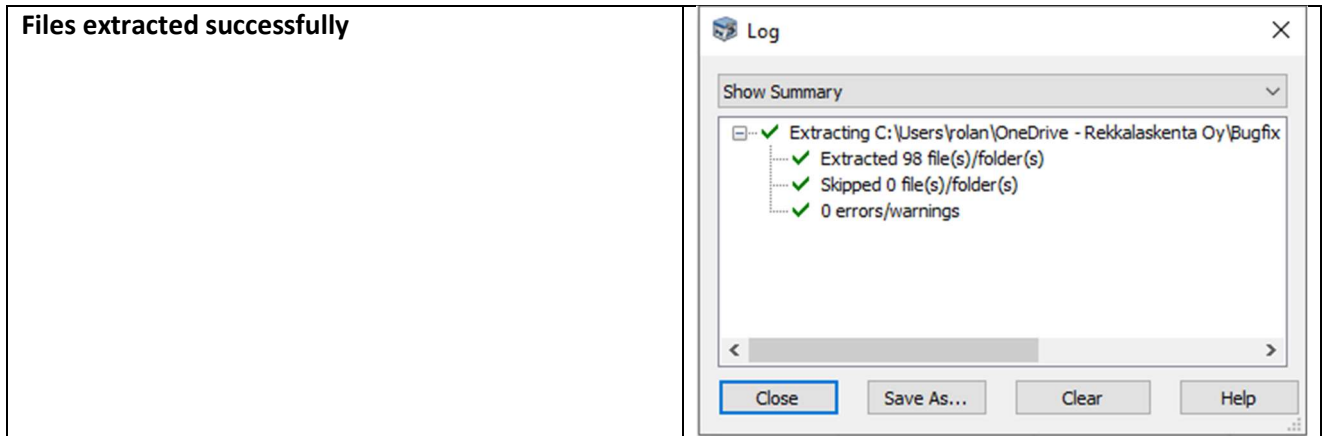

If you have an earlier version of TrailerWIN and need this crane range you need to order complete update.

If problem persists: [Please contact Trailer Consultation](#)

E-mail: info@trailerwin.com